

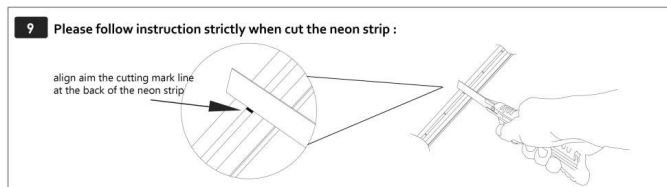

Attention: Please see this installation manual carefully. Incorrect bending may cause damage to the light strip, please be sure to strictly follow this instruction to operate and bend the light strip.

We declare : Quality problems caused by improper operation or bending are not covered by the warranty policy.

<p>1 Do not bend as following:</p> <p>Up & down bending (Top emitting)</p> <p>Lateral part (non-luminous side, as white)</p> <p>luminous-emitting surface</p> <p>Right bending</p>	<p>2 Bending with a radius of less than 150mm is strictly prohibited</p> <p>R150mm Minimum bending radius</p> <p>Ø300mm Minimum bending diameter</p>
<p>3 Do not to twist the neon strip in these direction</p>	<p>4 Do not to turn on the neon strip with roll-folding</p> <p>Power Supply</p>
<p>5 Do not to pedal hard or heavy pressure on strip</p>	<p>6 Do not to drag hard the connection of the neon strip body</p>
<p>7 Do not pull the neon strip</p>	<p>8 Do not to connect the light strip directly with the AC 220V (high-voltage)</p> <p>AC 220V</p>



Installation Step :

1 After drilling holes in the wall (not required for wooden walls) tap in the rubber plug and then fix the aluminum clip with screws.

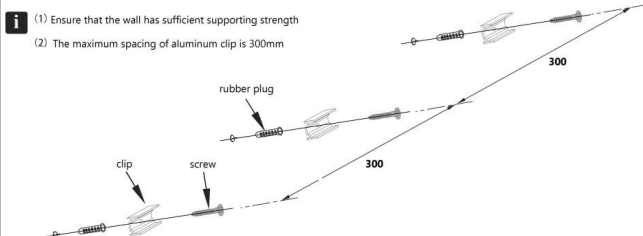

2 Install the neon strip

i (1) Before installing the light strip, do not open the rolled neon strip to prevent damage by twisting
(2) Please help to hold the neon strip avoid deformation caused by gravity

